

SMART WATER METER

SMART WATER METER

Data Sheet

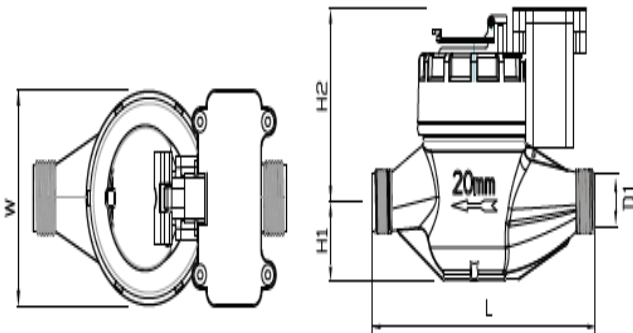

Teknovate Smart Water Meter is a Low Power long-range wireless radio frequency technology (LoRaWAN) based device. This highly secured data transmission technology required for Internet of Things (IoT) applications enables real-time communication of data and analytics that can be utilized to enhance efficiency and productivity.

The device is designed to measure Volume consumption of cold potable water and Flow rate of water. The meter also has value added smart functions such as totalizer, flow rate, flow directions (forward/reverse), data-logging, leak detection, tamper alarms.

The device communicates with the LoRa Gateway using the standard LoRaWAN protocol and the data is transmitted to the network server. The web application processes this data and takes appropriate action like sending SMS, E-Mail and alerts to the registered users.

Device Features

- Automatic meter reading that collects data remotely and automatically.
- Battery level alarm & Reverse flow alarm
- Innovative Magnet-Free measuring technology
- Designed for horizontal installation
- Low battery alarm and Magnetic fraud alarm
- Operating time of the leak, Leak volume and Leak flow
- Live data monitor on web.
- Historical analysis and Data management
- SMS & Email Alert is configured to the registered mobile number
- Map of sensors

Applications

- Commercial building
- Residential building
- Sub metering
- Industries

Technical Specifications

Wireless Frequency Band	EU 863~870 MHz / US 902~928 MHz / India 865~867 MHz / AS 923 MHz
Modulation	Based on IEEE 802.15.4g
LoRa Solution	Semtech SX-1276
Receive Sensitivity:	Typ. -136dBm @BW=125KHz with SF=10
Transmit Power	20dBm
Communication Interval	1~1440 minutes
Power	Built in Battery 3.6 VDC
Data Transmission	Forward / Back flow; Totalizer; Smart Functions (LNOUHB day); Configurable
Security	AES128
Network	GSM/GPRS
Antenna Type	Internal
Operation Temperature	-20°C to 70°C
Protection Requirements	IP68

Dimensional (Units in mm)

Model	Diameter (D) mm(inch)	Length max (L)	Max Width (W±2)	From Bottom to Aperature (H1)	From Head to Aperature (H2±2)	Thread Diameter (D1±0.3)	Approx. Weight (kg)	Threads Numbers Avg.25.4mm
PH15	15(½")	165	95.5	42.0	102.0	26.0	0.88	11
PH20	20(¾")	195	95.0	40.3	103.7	32.9	0.95	11
PH25	25(1")	225	99.5	46.5	108.5	41.0	1.15	11

About Teknovate

Today's dynamic world demands businesses to respond quickly through realizing automation in the end-to-end procedure. IoT technology is transforming the way we connect to the devices automatically. Service providers must adopt scalable, flexible and agile models to tap the client's requirements and expectations. Teknovate Technologies Pvt Ltd has responded to this market trend and developing robust and innovative smart city products for its customers.

Driven by over decade of industry experience, highly skilled technicians and wide geographical presence, we are continuously expanding our business worldwide and giving stiff competition to other IoT product manufacturers. We supply our products for various business verticals.

For more information about the Teknovate solution email us at iot@teknovateinc.com